

MODEL	D
SM2863-5155	305
SM2863-5126	800

T IS THE EARTH TERMINAL.

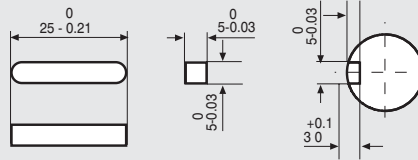

Dimensions in mm.

FEATURES CARATTERISTICHE		SM2863 - 5155 (SM2863 - 5126)
MODEL MODELLO		SM2863 - 5155 (SM2863 - 5126)
BASIC STEP ANGLE		1.8° ± 0.09°
BIPOLAR PARALLEL CURRENT	(Amp)	4
RESISTANCE	(Ohm)	1
INDUCTANCE	(mH)	7.9
BIPOLAR HOLDING TORQUE	(Ncm)	920
ROTOR INERTIA	(Kgm ² x 10 ⁻⁷)	4500
THEORETICAL ACCELERATION	(rad x sec. ⁻²)	20500
BACK E.M.F.	(V/Krpm)	241
MASS	(Kg)	4
INTERNATIONAL STANDARDS		UL, CSA, CE, RoHS
INSULATION VOLTAGE	(V)	250 Vac (350 Vdc)
PROTECTION DEGREE - INSULATION CLASS		IP43 - F
LEADS CODE		V

Codes between brackets refer to double shaft models.
Le sigle fra parentesi si riferiscono ai modelli bialbero.

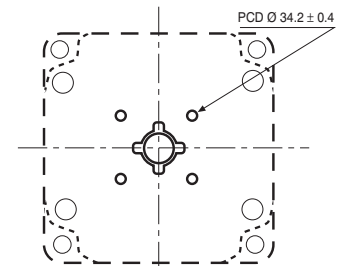
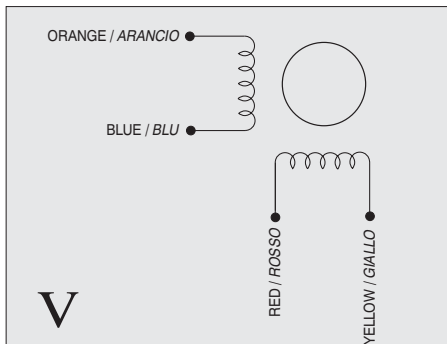
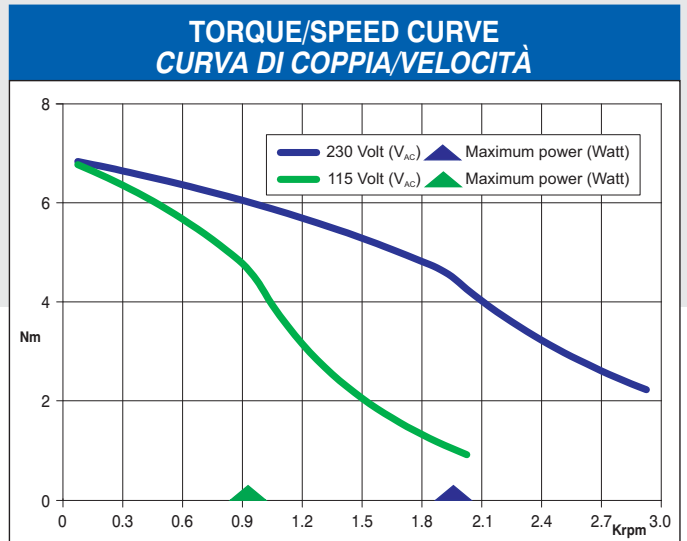

DOUBLE SHAFT MOTORS ONLY.
4 X M4 THREADED HOLES. TAP DEPTH 4.5 mm.

Suggested R.T.A. driver: X-PLUS B Series, X-MIND Series.