

T IS THE EARTH TERMINAL.

Dimensions in mm.

**FEATURES**  
**CARATTERISTICHE**

MODEL MODELLO	SM2863 - 5255 (SM2863 - 5225)
BASIC STEP ANGLE	1.8° ± 0.09°
BIPOLAR PARALLEL CURRENT (Amp)	6
RESISTANCE (Ohm)	0.46
INDUCTANCE (mH)	3.8
BIPOLAR HOLDING TORQUE (Ncm)	920
ROTOR INERTIA (Kg <sup>m</sup> 2 x 10 <sup>-7</sup> )	4500
THEORETICAL ACCELERATION (rad x sec. <sup>-2</sup> )	20500
BACK E.M.F. (V/Krpm)	161
MASS (Kg)	4
INTERNATIONAL STANDARDS	UL, CSA, CE, RoHS
INSULATION VOLTAGE (V)	250 Vac (350 Vdc)
PROTECTION DEGREE - INSULATION CLASS	IP43 - F
LEADS CODE	V

Codes between brackets refer to double shaft models.  
Le sigle fra parentesi si riferiscono ai modelli bialbero.

**TORQUE/SPEED CURVE**  
**CURVA DI COPPIA/VELOCITÀ**

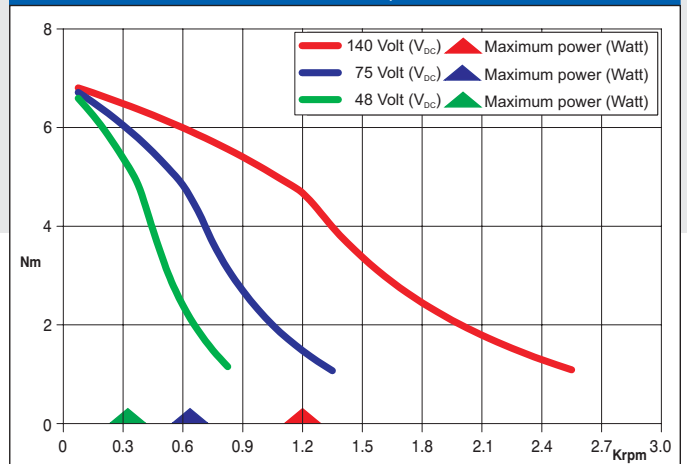

R.T.A. s.r.l. PAVIA (ITALY) SANYO DENKI CO., Ltd (JAPAN)

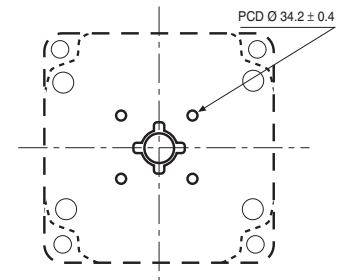
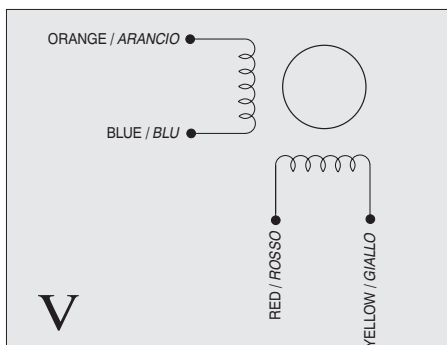

DOUBLE SHAFT MOTORS ONLY.  
4 X M4 THREADED HOLES. TAP DEPTH 4.5 mm.

Suggested R.T.A. driver: NDC Series, HGD Series, PLUS Series.